

RGBW Z-wave Slave Controller

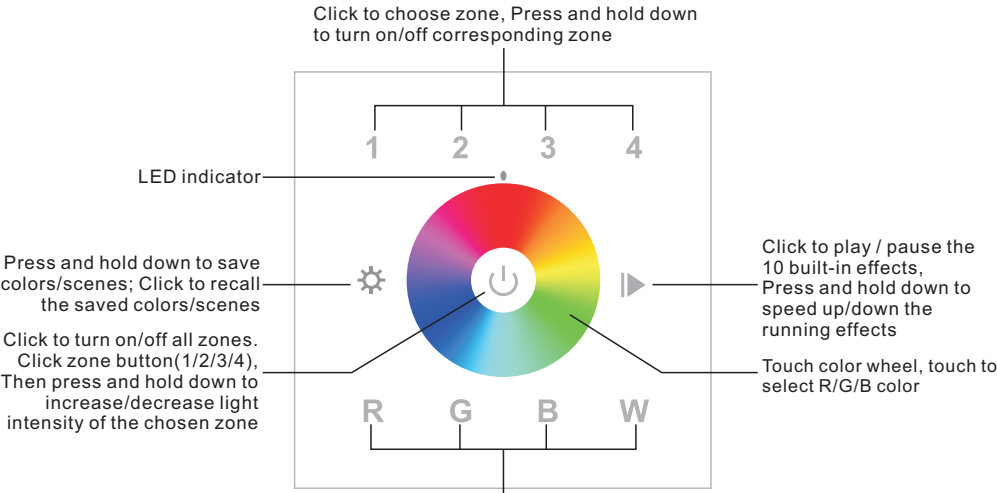

Important: Read All Instructions Prior to Installation

Function introduction



R/G/B/W 4channels:Click to turn off/on the channel
Press and hold down to increase/decrease light intensity of each channel

Front side

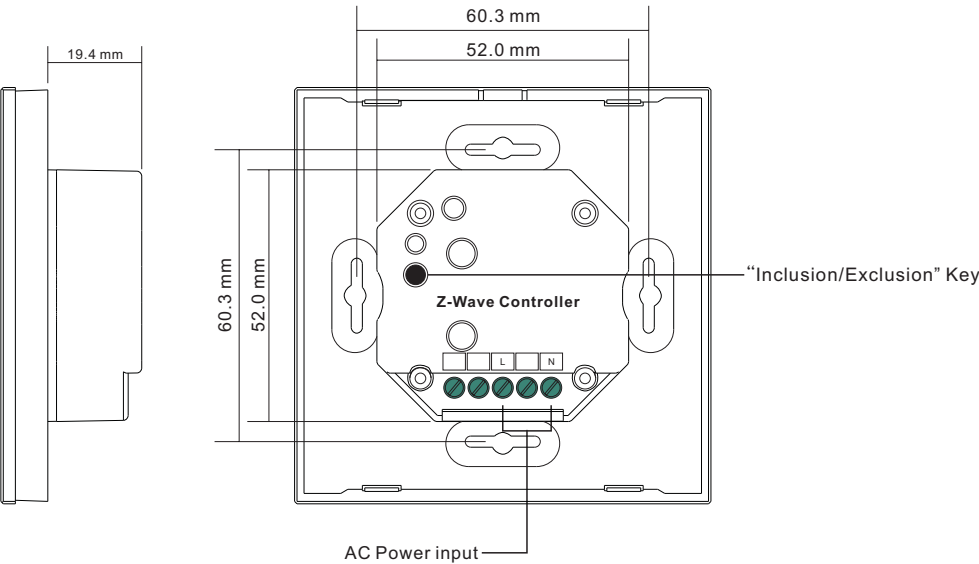

Back side

Product Data

Output	Z-Wave signal
Operation Frequency	868.40MHz
Transmission Range (free field)	30m
Power Supply	100-240V AC

Operating temperature	0-40°C
Relative humidity	8% to 80%
Dimensions	86x86x29.1mm

- Full touch control
- Z-wave mesh network
- Compatible with all universal z-wave master controllers or gateway
- Control 4 groups

Safety & Warnings

- DO NOT install with power applied to device.
- DO NOT expose the device to moisture.

Operation

- 1.Do wiring according to connection diagram correctly.
- 2.The wall controller is a secondary controller that does not support Z-Wave network administrator feature and will always need a Master (Primary) Z-Wave network controller to be added into a Z-Wave network.
- 3.The wall mounted controller is Z-Wave Plus enabled, on-wall mountable wireless controller that is able to control associated receiver devices. This device can control 4 Groups (Light Zones) with associated nodes.

Technical Data

SDK	6_61_00
Radio protocol	Z-Wave Plus
Explorer Frame Support	Yes
Basic Device Class	BASIC_TYPE_ROUTING_SLAVE
GenericDevice Class	GENERIC_TYPE_GENERIC_CONTROLLER
Specific Device Class	SPECIFIC_TYPE_REMOTE_CONTROL_SIMPLE

Z-Wave Plus Info Report

Parameter	Value
Z-Wave Plus Version	1
Role Type	5 (ZWAVEPLUS_INFO_REPORT_ROLE_TYPE_SLAVE_ALWAYS_ON)
Node Type	0 (ZWAVEPLUS_INFO_REPORT_NODE_TYPE_ZWAVEPLUS_NODE)
Installer Icon Type	0x0B00 (ICON_TYPE_GENERIC_REMOTE_CONTROL_SIMPLE)
User Icon Type	0x0B00 (ICON_TYPE_GENERIC_REMOTE_CONTROL_SIMPLE)

Manufacturer Specific Report

Parameter	Value (hex)
Manufacturer ID 1	0x00
Manufacturer ID 2	0x00
Product Type ID 1	0x00
Product Type ID 2	0x03
Product ID 1	0xa1
Product ID 2	0x01-0x0c

Association Command Class

Association Group	Group Name	Nodes	Send Mode	Send commands
Group 1	Lifeline	[1]	Single Cast	DEVICE_RESET_LOCALLY_NOTIFICATION (Sent when factory reset the remote)
Group 2	Launch 1	[1,12]	Singlecast/ Multicast (The touch color wheel uses multicast to send packets)	the Basic Set, Switch Multilevel Start Level Change, Switch Multilevel Stop Level Change, Switch Multilevel Set, Switch Color Set, Scene Activation, Scene Actuator Conf Set, Central Scene Notification
Group 3	Launch 2	[1,12]	Singlecast/ Multicast (The touch color wheel uses multicast to send packets)	the Basic Set, Switch Multilevel Start Level Change, Switch Multilevel Stop Level Change, Switch Multilevel Set, Switch Color Set, Scene Activation, Scene Actuator Conf Set, Central Scene Notification
Group 4	Launch 3	[1,12]	Singlecast/ Multicast (The touch color wheel uses multicast to send packets)	the Basic Set, Switch Multilevel Start Level Change, Switch Multilevel Stop Level Change, Switch Multilevel Set, Switch Color Set, Scene Activation, Scene Actuator Conf Set, Central Scene Notification
Group 5	Launch 4	[1,12]	Singlecast/ Multicast (The touch color wheel uses multicast to send packets)	the Basic Set, Switch Multilevel Start Level Change, Switch Multilevel Stop Level Change, Switch Multilevel Set, Switch Color Set, Scene Activation, Scene Actuator Conf Set, Central Scene Notification

4. Added to z-wave network

Set z-wave master (primary) controller into network inclusion mode (please refer to their manual to learn how) -> click the "Inclusion/Exclusion" key on the back of the slave controller (or press and hold down the switch key  until LED indicator turns on) -> there shall be an indication on master controller or z-wave gateway -> the LED indicator of slave controller flashes 6 times quickly to indicate successful adding

5.2 All COMMAND CLASS supported when working as a slave controller are as follows:

COMMAND_CLASS_ZWAVEPLUS_INFO,
COMMAND_CLASS_ASSOCIATION_V2,
COMMAND_CLASS_ASSOCIATION_GRP_INFO,
COMMAND_CLASS_MULTI_CHANNEL_ASSOCIATION_V2,
COMMAND_CLASS_MULTI_CHANNEL_V3,
COMMAND_CLASS_VERSION,
COMMAND_CLASS_MANUFACTURER_SPECIFIC,
COMMAND_CLASS_CONFIGURATION,
COMMAND_CLASS_DEVICE_RESET_LOCALLY,
COMMAND_CLASS_POWERLEVEL,
COMMAND_CLASS_FIRMWARE_UPDATE_MD_V2,
COMMAND_CLASS_MARK,
COMMAND_CLASS_BASIC,
COMMAND_CLASS_SWITCH_BINARY_V2,
COMMAND_CLASS_SWITCH_MULTILEVEL_V4,
COMMAND_CLASS_SWITCH_COLOR_V3,
COMMAND_CLASS_CENTRAL_SCENE_V2,
COMMAND_CLASS_SCENE_ACTIVATION,
COMMAND_CLASS_SCENE_ACTUATOR_CONF,

6. Removed from z-wave network

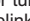
- When the slave controller has already been added to z-wave network, set the z-wave master controller or z-wave gateway into network exclusion mode (please refer to their user manual to learn how) -> click the "Inclusion/Exclusion" key on the back of the slave controller (or press and hold down the switch key  until LED indicator turns on) -> there shall be an indication on the master controller -> the LED indicator shows 3 short blinks and 1 long blink to indicate successful removing
- Press and hold down "Inclusion/Exclusion" key on the back of the remote for over 10s until the LED indicator shows 3 short blinks and 1 long blink, which means successful factory reset.

Note: Resetting the device is not recommended and please only execute it in the event that your primary Controller is lost or otherwise inoperable, a reset of the device will clear all network information.

7. Group for Associations

This secondary controller supports 5 groups for associations:

Group 1: Lifeline (Used for reporting devices' state to the Master Controller if any changes happen). This group supports one node, which default association to the Master Controller node.

Group 2-5: each group supports maximum 12 controllable devices for association, the same device can be associated with multiple remotes simultaneously, and can be associated with multiple groups on the same remote simultaneously. (group number 1, 2, 3, 4 stands for group 2, 3, 4, 5 respectively). Please make sure to disassociate the controllable devices that are not in working status with the remote to ensure good control experience.

Once the remote and controllable devices are added to the network, choose from your gateway or hub interface to associate the device with the remote. (Please refer to their user manual to learn how).

8 Control the devices associated with this controller

• How to control the controllable devices:

Configure the remote via gateway with CC "COMMAND_CLASS_ASSOCIATION" or "COMMAND_CLASS_MULTI_CHANNEL_ASSOCIATION" to associate the controllable devices with the remote.

• How to undo the control to controllable devices:

Configure the remote via gateway with CC "COMMAND_CLASS_ASSOCIATION" or "COMMAND_CLASS_MULTI_CHANNEL_ASSOCIATION" to disassociate the controllable device with the remote.

Note: all configuration parameters for association will be removed automatically after the remote is removed from the network.

- Switch On/Off
- Group key: Press and hold down any of group numbers to switch on/off all receivers that are added to the corresponding group.
- Choose R/G/B/W channel to turn on/off each channel and adjust brightness of each channel by holding down the R/G/B/W channel key or brightness key
- Choose RGB color by slide touching the RGB touch color wheel
- Mode key: Click the Mode key to select a mode or pause a mode. Press and hold down Mode key to adjust mode speed, and each operation will adjust the speed from the slowest to the fastest step by step with total 32 levels of speed.

Wiring diagram

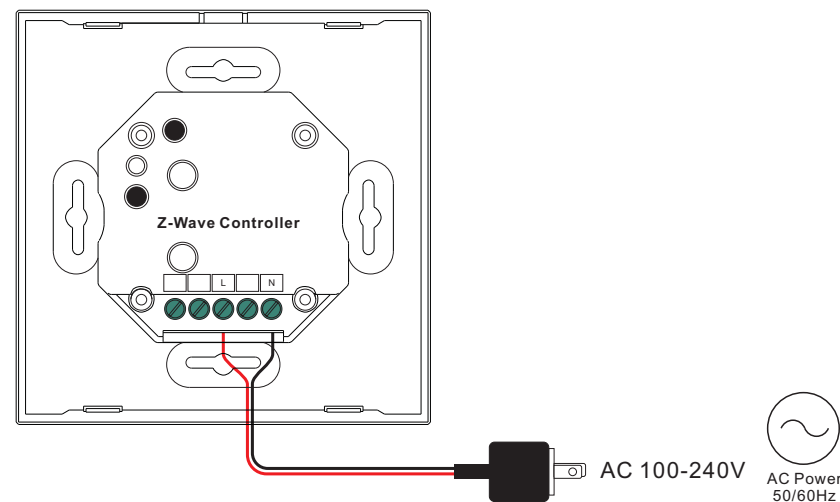

Installation

